

Onderdelen tekening / Exploded view

Microwave Oven

NE-2140 EYG

NE-3240 EYG

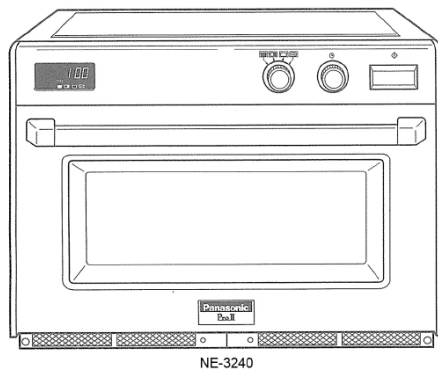

(Continental Europe)

Let op ! Please note ! :

de onderdelen in deze tekening zijn voor magnetrons geproduceerd na November 2023. Heeft u een ouder model neem dan contact met ons op via onderstaand email adres :

the parts in this drawing are for microwaves produced after November 2023. If you have an older model, please contact us at the email address below :

service@magnetron.biz

MCW
Magnetron
Centrum
Waalwijk

Panasonic[®]

© Panasonic Corporation 2021 Unauthorized copying and distribution is a violation of law.

TOP

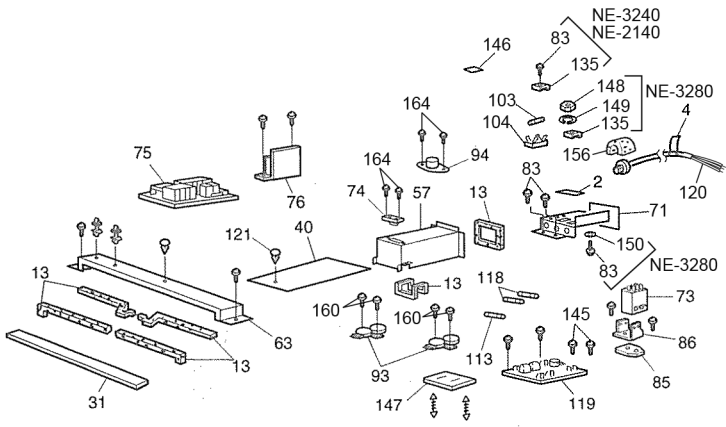

BACK SIDE

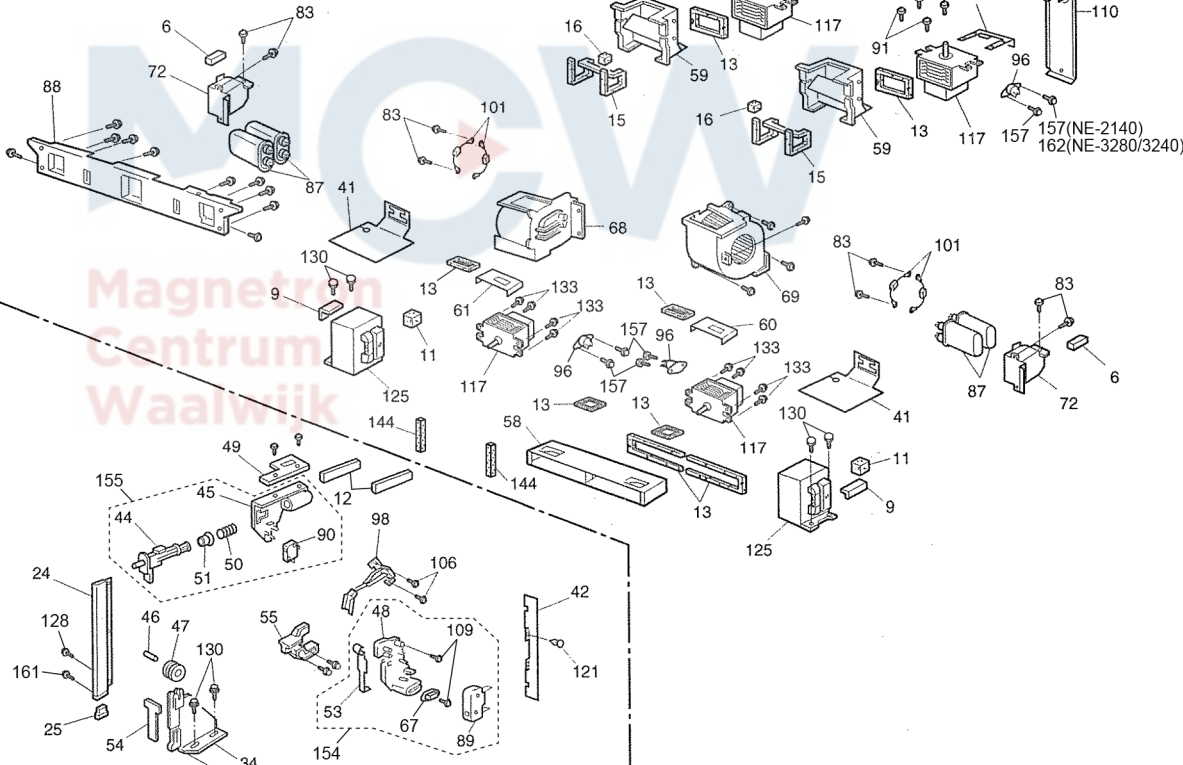
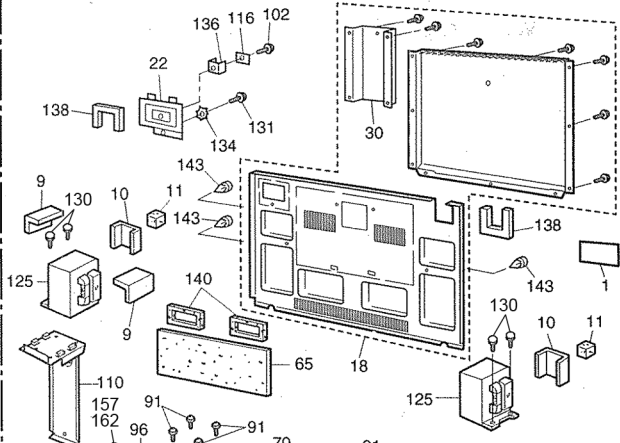

RIGHT SIDE

(S-3A4 BDQ)

12 PARTS LIST

NOTE: Part number are indicated on most mechanical parts. Please use these part numbers for parts orders.

Important safety notice:

Components identified by  mark have special characteristics important for safety.

When replacing any of these components, use only manufacture's specified parts.

Safety	Ref. No.	Part No.	Part Name & Description	Pcs/set	Remarks
	1	F00062Q0EP	CAUTION LABEL	1	NE-3240EYG, NE-2140EYG
	1	F00063C50BP	CAUTION LABEL	1	NE-3280BDQ
	2	F00333030GP	FUSE LABEL	1	NE-3240EYG, NE-2140EYG
	3	A010T3030GP	SHELF	1	
	4	F02393A80BP	CORD LABEL	1	NE-3280BDQ
	5	F05243A70EU	NAME LABEL	1	NE-2140EYG
	5	F05243A50EU	NAME LABEL	1	NE-3240EYG
	5	F05243A40BP	NAME LABEL	1	NE-3280BDQ
	6	F0911A00DC	CUSHION RUBBER B	2	NE-3280BDQ, NE-3240EYG
	7	F0911A00DF	CUSHION RUBBER B	1	
	8	F0911A00EG	CUSHION RUBBER B	2	
	9	F0911A00EH	CUSHION RUBBER B	2	NE-2140EYG
	9	F0911A00EH	CUSHION RUBBER B	4	NE-3280BDQ, NE-3240EYG
	10	F0911A00MG	CUSHION RUBBER B	2	NE-3280BDQ, NE-3240EYG
	11	F0917A00EB	CUSHION RUBBER B	2	FOR H.V.TRANSFORMER: UPPER(NE-3280BDQ, NE-3240EYG)
	12	F0921A00CG	CUSHION RUBBER C	2	
	13	F0922A00AO	CUSHION RUBBER C	14	
	14	F0922A00JE	CUSHION RUBBER C	1	
	15	F0923A00AU	CUSHION RUBBER C	2	
	16	F0924A00AB	CUSHION RUBBER C	2	
	17	F100A3560GP	BASE	1	NOTE 1
	18	F100Q3560GP	BACK PANEL	1	
	19	F1007-3280	FOOT	4	FOR BASE
	20	F1008-3280	RUBBER FOOT	4	FOR BASE
	21	F10093030GPS1	CABINET BODY KIT	1	NE-3240EYG, NE-2140EYG, WITH RECYCLE LABEL
	21	F10093030GPS	CABINET BODY KIT	1	NE-3280BDQ
	22	F101H3170GP	BACK PANEL COVER C	1	
	23	F10133030GP	LEFT SIDE SASH	1	
	24	F10143030GP	RIGHT SIDE SASH	1	
	25	F10203030GP	SASH RUBBER B	1	LEFT
	26	F10263030GP	OVEN LAMP COVER	1	
	27	F10283030GP	ANTENNA MOTOR COVER	2	
	28	F10503030GP	SASH RUBBER A	1	RIGHT
	30	F10593560GP	BACK PANEL COVER B	1	
	31	F11743060GP	SPACER	1	
	32	F16163030GP	PANEL B	1	NE-3240EYG, NE-2140EYG
	32	F16163060GP	PANEL B	1	NE-3280BDQ
	33	F200A3A40BAP	OVEN	1	
	34	F200P3030GP	ROLLER BRACKET A	1	RIGHT
	35	F200Q3030GP	ROLLER BRACKET B	1	LEFT
	36	F20103A40BP	CEILING PLATE B	2	
	37	A20113030GP	CEILING PLATE	1	
	38	F20193030GP	ANTENNA STOPPER	8	
	39	F202K3560GPS	ANTENNA KIT	4	
	40	F22173030GP	BARRIER SHEET A	1	
	41	F22183030GP	BARRIER SHEET B	2	NE-3280BDQ, NE-3240EYG
	42	F22193030GP	BARRIER SHEET C	1	NE-2140EYG
	42	F22193030GP	BARRIER SHEET C	2	NE-3280BDQ, NE-3240EYG
	43	F3008P00RN	HINGE PIN	2	
	44	F30183030GP	DOOR KEY A	2	
	45	F30203030GP	DOOR HOOK A	2	
	46	F3033-560	DOOR ROLLER PIN	2	
	47	ANE3034-560	DOOR GUIDE ROLLER	2	
	48	F31123030GP	DOOR HOOK B	2	NE-3240EYG, NE-2140EYG
	48	F31123050GP	DOOR HOOK B	2	NE-3280BDQ
	49	F31363030GP	HOOK SPACER A	2	
	50	ANE3155-610	SPRING	2	
	51	F3157-610	PACKING RUBBER	2	
	52	F31863A70EU	DOOR PANEL	1	NE-2140EYG
	52	F31863A50EU	DOOR PANEL	1	NE-3240EYG
	52	F31863A40BP	DOOR PANEL	1	NE-3280BDQ
	53	F32493030GP	DOOR SWITCH LEVER	2	
	54	F32523030GP	DOOR ARM SPACER	2	
	55	F33373030GP	DOOR ARM LEVER	2	
	56	F400B3040APS	AIR FILTER FLAME KIT	2	

Safety	Ref. No.	Part No.	Part Name & Description	Pcs/set	Remarks
	57	F400C3040AP	EXHAUST GUIDE B	1	
	58	F402N3030GP	EXHAUST GUIDE A	1	
	59	F40253030GP	AIR GUIDE A	2	
	60	F40263030GP	AIR GUIDE B	1	
	61	F40313030GP	AIR GUIDE C	1	
	63	F40473560GP	AIR GUIDE E	1	
	64	A40923030GP	FILTER HANDLE	1	
	65	F40963030GP	INSULATION SHEET	2	
	66	ANE42408U0AP	FILTER HANDLE B	2	
	67	F64083040AP	WASHER	2	
	68	F490W3A60BP	FAN MOTOR A	1	NE-2140EYG
	68	F490W3A50BP	FAN MOTOR A	1	NE-3280BDQ, NE-3240EYG
	69	F490Y3A60BP	FAN MOTOR B	1	NE-2140EYG
	69	F490Y3A50BP	FAN MOTOR B	1	NE-3280BDQ, NE-3240EYG
	70	H50328U0AP	MAGNETRON BRACKET	2	
	71	F600E3030GP	TERMINAL PLATE	1	
	72	F600S3030GP	CAPACITOR BRACKET	2	NE-2140EYG
	72	F600S3A40BP	CAPACITOR BRACKET	2	NE-3280BDQ, NE-3240EYG
△	73	A60043A50EU	POWER RELAY	1	NE-3240EYG, NE-2140EYG
	74	A601L4000AP	TEMP SENSOR	1	
	75	F603M3H30EU	PC BOARD B (U)	1	NE-2140EYG
	75	F603M3H50EU	PC BOARD B (U)	1	NE-3240EYG
	75	F603M3H40BP	PC BOARD B (U)	1	NE-3280BDQ
△	76	F603Y3560GP	L.V.TRANSFORMER (U)	1	
	77	F6030Q50GN	INCANDESCENT LAMP	1	(240V/25W)
	78	F60403030GP	OVEN LAMP SHEET	1	
	79	F64373A40AP	LAMP GLASS	1	
	80	F605Q3H50EU	PUSH SWITCH	1	
	81	F605S3H50EU	PC BOARD H (U)	1	
	82	F80163060GP	ESCUTCHEON SPACER	1	
	83	XYD4+EE12FJ	SCREW	19	NE-3240EYG, NE-2140EYG, (4X12) FOR ESCUTCHEON BASEx2, POWER SELECT SWITCH (EARTH)x1, TERMINAL PLATEx2, DIODE,SIx4, H.V.CAPACITORx2, ANTENNA MOTOR COVERx4, SPACER(Ref. No.135)x1, SWITCH HOLDERx1, CAPACITOR BRACKETx2
	83	XYD4+EE12FJ	SCREW	18	NE-3280BDQ, (4X12) FOR ESCUTCHEON BASEx2, TERMINAL PLATEx3, DIODE,SIx4, H.V.CAPACITORx2, ANTENNA MOTOR COVERx4, SWITCH HOLDERx1, CAPACITOR BRACKETx2
	84	F607V3A40APS	OVEN LAMP COVER KIT	1	
	85	F60823030GP	POWER RELAY BRACKET	1	NE-3240EYG, NE-2140EYG
	86	A60823A50EU	POWER RELAY BRACKET	1	NE-3240EYG, NE-2140EYG
△	87	J63903310GP	H.V.CAPACITOR	4	NE-2140EYG, (0.82µF, AC2300V) Replace together with CAPACITOR BRACKET.
△	87	J63903330GPS	H.V.CAPACITOR	4	NE-3280BDQ, NE-3240EYG, (1µF, AC2500V) Replace together with CAPACITOR BRACKET.
	88	F61073030GP	BRACKET	1	
△	89	A61423030GP	MICRO SWITCH	2	NE-3240EYG, NE-2140EYG, (A20G7-3C108) SAFETY SWITCH B (PRIMARY INTERLOCK SWITCH)
△	89	ANE6142-F60	MICRO SWITCH	2	NE-3280BDQ, (V-15G-3C26) SAFETY SWITCH B (PRIMARY INTERLOCK SWITCH)
△	90	ANE61424L0AG	MICRO SWITCH	2	(V-16G-3C26) SAFETY SWITCH A (SECONDARY INTERLOCK SWITCH)
	91	XYEA5+C16TJ	SCREW	8	(5X16) FOR MAGNETRON: UPPER
△	92	J6144-3E20	ANTENNA MOTOR	2	(2.5W), LOWER
△	93	J6144-3E10	ANTENNA MOTOR	2	(2.5W), UPPER
△	94	F61454000AP	THERMAL CUTOUT	1	FOR OVEN
△	95	F61454050AP	THERMAL CUTOUT	2	FOR ANTENNA MOTOR
△	96	F61454210AP	THERMAL CUTOUT	2	FOR MAGNETRON
△	97	F61523C00BP	SOCKET	1	
△	98	A61583030GP	DOOR SWITCH A	1	RIGHT, SHORT SWITCH (INTERLOCK MONITOR SWITCH)
△	99	A61583050GP	DOOR SWITCH B	1	LEFT, SHORT SWITCH (INTERLOCK MONITOR SWITCH)
	100	F61703030GP	INSULATION SHEET C	1	
	101	A6202-3280	DIODE,SI	4	
	102	XYE6+F20FJ	SCREW	1	(6X20) FOR BACK PANEL COVER C
△	103	A62303030EP	FUSE	1	NE-3240EYG, NE-2140EYG, (20A)
	104	F6231H10RN	FUSE HOLDER	1	NE-3240EYG, NE-2140EYG
	105	F62383030GP	SPACER	2	
	106	XYN4+F12SJ	SCREW	4	(4X12) FOR DOOR SWITCH
	108	F65313030GP	SWITCH HOLDER	1	
	109	XYN4+F18SJ	SCREW	4	(4X18) FOR DOOR HOOK B
	110	F65513030GP	H.V.T.MOUNTING	2	NE-3280BDQ, NE-3240EYG
	111	F65613030GP	BUZZER CASE	1	
	112	F18593560GP	SHELF SUPPORT	2	
△	113	A65953030GP	FUSE B	1	NE-3240EYG, NE-2140EYG, (3A)

Safety	Ref. No.	Part No.	Part Name & Description	Pcs/set	Remarks
△	113	A65953700BP	FUSE B	1	NE-3280BDQ, (2.5A)
	114	F66033030GP	OVEN LAMP BRACKET	1	
	115	F66263040AP	THERMAL CUTOFF MOUNT	2	
	116	F66623171BGP	EARTH SPACER	1	
△	117	2M210-M1JLF	MAGNETRON	4	NE-2140EYG
△	117	2M244-M1JL	MAGNETRON	4	NE-3280BDQ, NE-3240EYG
△	118	A67593560GP	FUSE	2	NE-2140EYG, (7A)
△	118	A67593030GP	FUSE	2	NE-3240EYG, (10A)
△	118	A62303580GP	FUSE	2	NE-3280BDQ, (20A)
△	119	F692Y3560GP	NOISE FILTER (U)	1	NE-2140EYG
△	119	F692Y3A50EU	NOISE FILTER (U)	1	NE-3240EYG
△	119	F692Y3A40BP	NOISE FILTER (U)	1	NE-3280BDQ
△	120	F90243560GPS	POWER CORD W/OUT PLUG U	1	NE-2140EYG
△	120	F90243A50EUS	POWER CORD W/OUT PLUG U	1	NE-3240EYG
△	120	F90243A40BPS	POWER CORD W/OUT PLUG U	1	NE-3280BDQ
	121	ANE9080-730	CLIP (YELLOW)	2	NE-2140EYG
	121	ANE9080-730	CLIP (YELLOW)	3	NE-3280BDQ, NE-3240EYG
	122	ANE90828U0AP	CLIP (BLACK)	2	
	123	A90823960AP	CLIP	8	
	124	F98363030GP	CASE	1	
△	125	J622B3A70EU	H.V.TRANSFORMER	2	NE-2140EYG
△	125	J622B3A50EU	H.V.TRANSFORMER	4	NE-3240EYG
△	125	J622B3A50BP	H.V.TRANSFORMER	4	NE-3280BDQ
	126	F83613030GP	SWITCH SPACER	1	
	127	XST4+6VS	SCREW	8	(4X6) FOR ANTENNA
	128	XTC4+10BC	SCREW	9	(4X10) FOR CABINET BODY KITx6, LEFT SIDE SASH, RIGHT SIDE SASH, OVEN LAMP COVER
	129	XTC4+12BKJ	SCREW (BLACK)	3	(4X12) FOR BASE
	130	XTEA5+10BJ	SCREW	12	NE-3280BDQ, NE-3240EYG, (5X10) FOR H.V.TRANSFORMERx8, ROLLER BRACKET Ax2, ROLLER BRACKET Bx2
	130	XTEA5+10BJ	SCREW	8	NE-2140EYG, (5X10) FOR H.V.TRANSFORMERx4, ROLLER BRACKET Ax2, ROLLER BRACKET Bx2
	131	XTT4+8EJ	SCREW	1	(4X8) FOR BACK PANEL COVER C
	132	XTW3+8BJ	SCREW	4	(3X8) FOR FOOT
	133	XTWA4+10RUJ	SCREW	8	(4X10) FOR MAGNETRON: LOWER
	134	XWC4BPN	WASHER	2	FOR ESCUTCHEON BASE, BACK PANEL COVER C
	135	XWNF53GV	SPACER	1	FOR TERMINAL PLATE (POWER CORD EARTH)
	136	XWNANE66GV	SPACER	1	FOR BACK PANEL COVER C
	137	XTS4+10FC	SCREW	1	(4X10) FOR ESCUTCHEON BASE
	138	F0961A00ZI	CUSHION RUBBER D	2	
	139	F0962A00ZE	CUSHION RUBBER D	2	
	140	F0963A00AX	CUSHION RUBBER D	2	
	141	XNW5EFN	NUT	2	FOR SHELF SUPPORT
	142	XWG5BV	WASHER	2	FOR SHELF SUPPORT
	143	A91433040AP	CLIP	3	NE-2140EYG
	143	A91433040AP	CLIP	1	NE-3280BDQ, NE-3240EYG
	144	F10493030GP	CUSHION RUBBER	2	
	145	XYN5+C8BN	SCREW	2	NE-3280BDQ, (5X8) FOR NOISE FILTER
	146	F02433560GP	TERMINAL LABEL	1	NE-3240EYG, NE-2140EYG, ("L2")
	147	F608E3H00EU	P.C. BOARD Q	1	NE-3280BDQ, NE-3240EYG
	148	XNG4EVS	NUT	1	NE-3280BDQ, FOR CORD EARTH
	149	XWA4BV	WASHER	1	NE-3280BDQ, FOR CORD EARTH
	150	XWA5BV	WASHER	1	NE-3280BDQ, FOR CORD EARTH
	152	F0922A00AOU	CUSHION RUBBER C	1	
	153	F0923A00AI	CUSHION RUBBER C	2	
	154	F610A3030GP	DOOR SWITCH A U	2	NE-3240EYG, NE-2140EYG, NOT INCLUDING WASHER(Ref. No.67), SCREW(Ref. No.109)
	154	F610A3050EP	DOOR SWITCH A U	2	NE-3280BDQ, NOT INCLUDING WASHER(Ref. No.67), SCREW(Ref. No.109)
	155	F393C3030GP	DOOR HOOK U	2	
	156	F0921A00CD	CUSHION RUBBER C	1	NE-3240EYG, FOR TERMINAL PLATE
	157	XTEA3+6BJ	SCREW	8	NE-2140EYG, (3X6) FOR THERMAL CUTOFF(Ref. No.96)
	157	XTEA3+6BJ	SCREW	6	NE-3280, NE-3240, (3X6) FOR THERMAL CUTOFF(Ref. No.96)
	158	XTF3+10GJ	SCREW	2	(3X10) FOR CASE
	159	XTN3+6QJ	SCREW	2	(3X6) FOR PUSH SWITCH
	160	XTW3+6BJ	SCREW	8	(3X6) FOR ANTENNA MOTOR
	161	XTEANE4+6BN	SCREW	2	(4X6) FOR SASH RUBBER A, SASH RUBBER B
	162	XYF4+AF6J	SCREW	2	NE-3280BDQ, NE-3240EYG, (4X6)
	163	XYD4+BR8FN	SCREW	1	NE-3280BDQ, (4X8) FOR MEMBRANE SWITCH KIT (EARTH)
	164	XTWANE3+8EX	SCREW	4	(3X8) FOR THERMAL CUTOFF(Ref. No.94), TEMP SENSOR
		F65448U0AP	SPACER	4	FOR BUZZER CASE

Safety	Ref. No.	Part No.	Part Name & Description	Pcs/set	Remarks
		XTW4+12TJ	SCREW	11	(4X12) FOR DOOR HOOK Ux4, BASEx2, DOOR ARM LEVERx4, BUZZER CASEx1
		XTWANE4+10BN	SCREW	8	(4X10) FOR PC BOARD B (U)x2, FAN MOTOR Ax2, FAN MOTOR Bx2, NOISE FILTER (U)x2
		XTWANE4+12DN	SCREW	45	(4X12) FOR CABINET BODY KITx9, BACK PANEL COVER Ax8, H.V.T.MOUNTINGx6, BASEx4, AIR GUIDE Ex2, EXHAUST GUIDE Bx2, etc.
		XTNB4+F10BFB	SCREW	1	NE-3240EYG, NE-2140EYG, (4X10) FOR FUSE HOLDER(Ref. No.104)

NOTE 1: Please order NAME LABEL(Ref. No.5) together.



13 DOOR ASSEMBLY

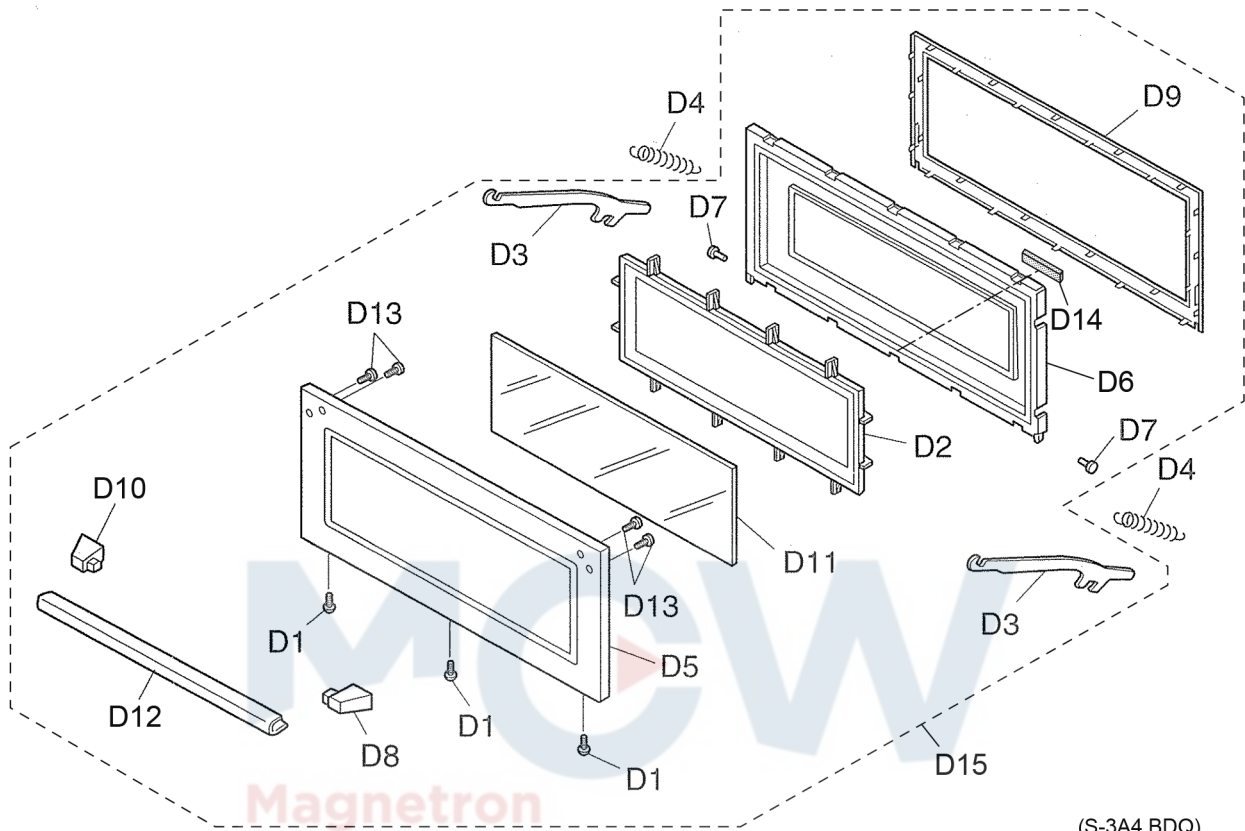

(S-3A4 BDQ)

Safety	Ref. No.	Part No.	Part Name & Description	Pcs/set	Remarks
	D1	XTC4+10BC	SCREW	3	(4X10)
	D2	F30033030GP	DOOR FRAME	1	
	D3	F30043030GP	DOOR ARM	2	
	D4	F3009P00RN	DOOR SPRING	2	
	D5	F301A3030GP	DOOR A	1	NOTE 1
	D6	F301P3030GP	DOOR E	1	NOTE 2
	D7	F3036P00RN	DOOR ARM PIN	2	
	D8	F30703A60GP	HANDLE PIECE A	1	
	D9	F30853030GP	DOOR C	1	
	D10	F31343A60GP	HANDLE PIECE B	1	
	D11	F31463030GP	DOOR SCREEN B	1	
	D12	F31473030GP	HANDLE PIECE C	1	
	D13	XVEA4+C16TJ	SCREW	4	(4X16)
	D14	F0911A00DG	CUSHION RUBBER	1	
	D15	F390L3030GPS	DOOR U	1	NOTE 1

NOTE 1: Please order DOOR PANEL(Ref. No.52) together.

NOTE 2: Please order CUSHION RUBBER(Ref. No.D14) together.

14 ESCUTCHEON BASE ASSEMBLY

NE-2140, NE-3240

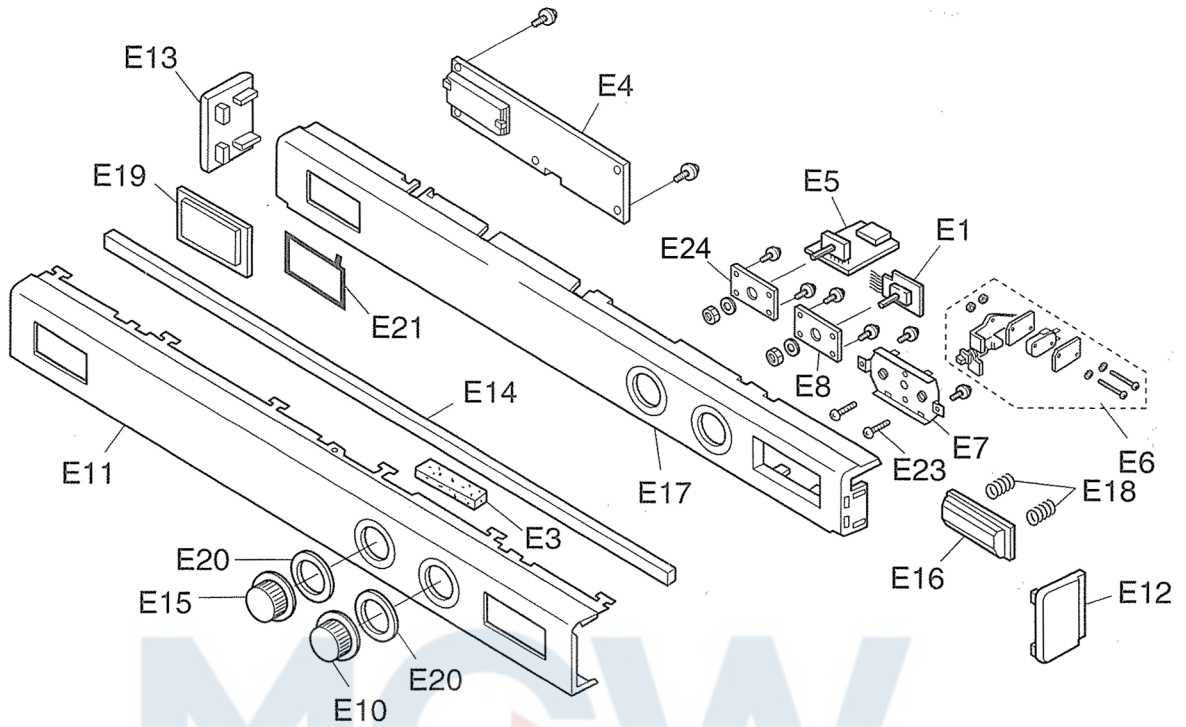

(S-3A5 EYG)

NE-3280

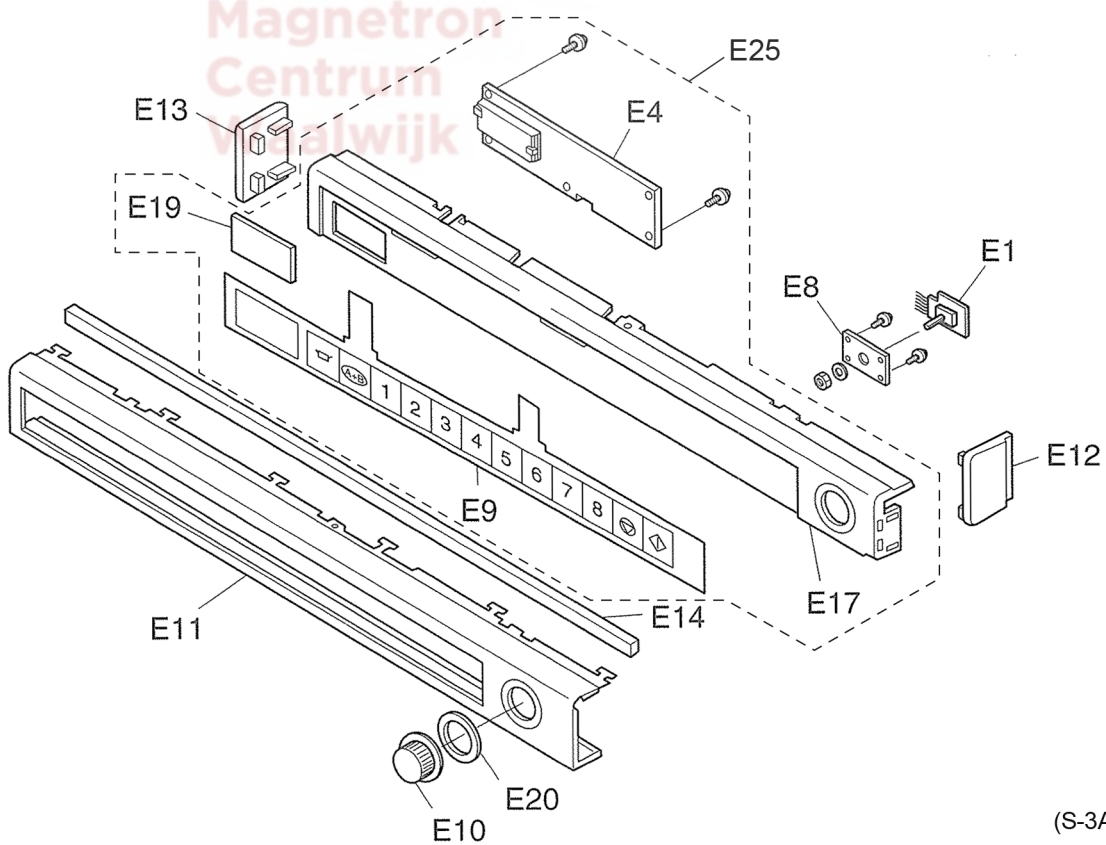

(S-3A4 BDQ)

Safety	Ref. No.	Part No.	Part Name & Description	Pcs/set	Remarks
	E1	F608C3H00EU	TIMER (ROTARY ENCODER)	1	
	E3	F1062-8U0	CUSHION RUBBER B	1	NE-3240EYG, NE-2140EYG
⚠	E4	F603L3H10EU	D.P.CIRCUIT (U)	1	NE-3240EYG, NE-2140EYG
⚠	E4	F603L3H00EU	D.P.CIRCUIT (U)	1	NE-3280BDQ
	E5	F608T3H10EU	POWER SELECT SWITCH	1	NE-3240EYG, NE-2140EYG
	E6	F610E3600BP	START SWITCH	1	NE-3240EYG, NE-2140EYG
	E7	A61623030GP	START SWITCH BRACKET	1	NE-3240EYG, NE-2140EYG
	E8	F63433030GP	TIMER BRACKET	1	
⚠	E9	F630Y3H00EUS	MEMBRANE SWITCH KIT	1	NE-3280BDQ
	E10	F800D3060GP	TIMER KNOB	1	
	E11	F80013030GP	ESCUTCHEON A	1	NE-3240EYG, NE-2140EYG
	E11	F80013060GPS	ESCUTCHEON A KIT	1	NE-3280BDQ, WITH SPACER (Ref. No.31)
	E12	F80023A60GP	ESCUTCHEON B	1	
	E13	F80063A60GP	ESCUTCHEON D	1	
	E14	F80163030GP	ESCUTCHEON SPACER	1	
	E15	F800D3030GP	TIMER KNOB	1	NE-3240EYG, NE-2140EYG
	E16	F80243A50EU	COOK BUTTON	1	NE-3240EYG, NE-2140EYG
	E17	F80343030GP	ESCUTCHEON BASE	1	NE-3240EYG, NE-2140EYG
	E17	F80343060GP	ESCUTCHEON BASE	1	NE-3280BDQ
	E18	ANE8037P00RN	COOK BUTTON SPRING	2	NE-3240EYG, NE-2140EYG
	E19	F81263H10EU	SMOKE PANEL	1	NE-3240EYG, NE-2140EYG
	E19	F81263H00EU	SMOKE PANEL	1	NE-3280BDQ
	E20	A82873030GP	SPACER A	2	NE-3240EYG, NE-2140EYG
	E20	A82873030GP	SPACER A	1	NE-3280BDQ
	E21	F83373560GP	ESCUTCHEON SHEET	1	NE-3240EYG, NE-2140EYG
	E23	XYN4+C88J	SCREW	2	NE-3240EYG, NE-2140EYG, (4X8)
	E24	F63433H10EU	BRACKET	1	NE-3240EYG, NE-2140EYG
	E25	F800L3H00EUS	ESCUTCHEON BASE (U)	1	NE-3280BDQ



15 PACKING AND ACCESSORIES

Cut into three parts when packing.

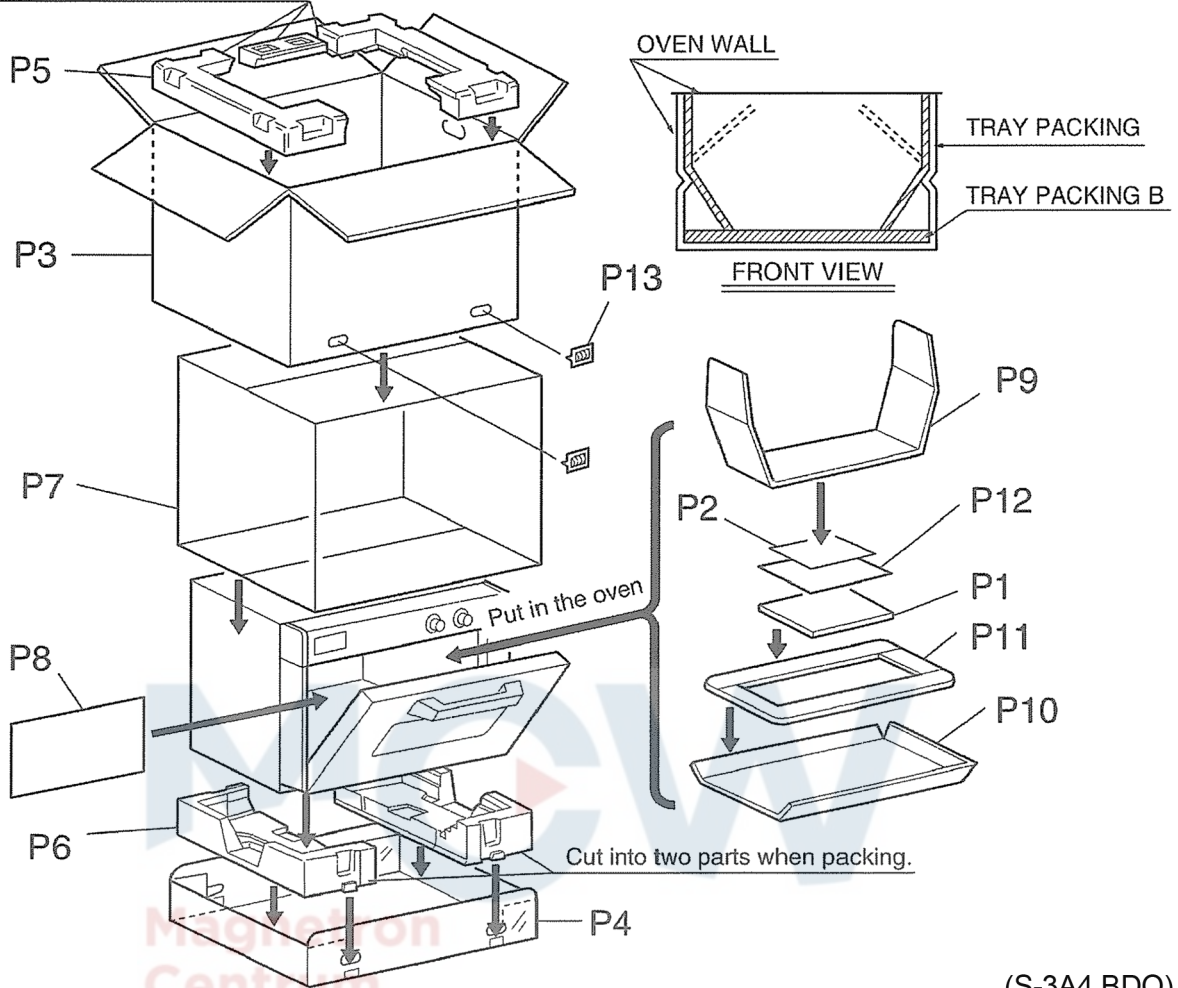

(S-3A4 BDQ)

Safety	Ref. No.	Part No.	Part Name & Description	Pcs/set	Remarks
	P1	F00033A50EU	INSTRUCTION BOOK	1	NE-3240EYG, NE-2140EYG
	P1	F000Q3A40BP	INSTRUCTION BOOK	1	NE-3280BDQ
	P2	F01723F90EU	CAUTION LABEL	1	
	P3	F01023A70GPS	PACKING CASE, PAPER	1	NE-2140EYG
	P3	F01023A50GPS	PACKING CASE, PAPER	1	NE-3240EYG
	P3	F01023A40GPS	PACKING CASE, PAPER	1	NE-3280BDQ
	P4	F01033030GPS1	BOTTOM CASE	1	NE-3240EYG, NE-2140EYG, WITH RECYCLE LABEL
	P4	F01033030GP	BOTTOM CASE	1	NE-3280BDQ
	P5	F01043030GP	UPPER FILLER	1	
	P6	F01053030GP	LOWER FILLER	1	
	P7	F01063040AP	VINYL COVER	1	
	P8	F01073030GPS1	DOOR SHEET	1	NE-3240EYG, NE-2140EYG, WITH RECYCLE LABEL
	P8	F01073030GP	DOOR SHEET	1	NE-3280BDQ
	P9	F01083030GPS1	TRAY PACKING	1	NE-3240EYG, NE-2140EYG, WITH RECYCLE LABEL
	P9	F01083030GP	TRAY PACKING	1	NE-3280BDQ
	P10	F01173030GPS1	TRAY PACKING B	1	NE-3240EYG, NE-2140EYG, WITH RECYCLE LABEL
	P10	F01173030GP	TRAY PACKING B	1	NE-3280BDQ
	P11	A012D3050GP	SHELF B	1	
	P12	F04203590BP	OPERATING GUIDE	1	NE-3280BDQ
	P13	NHP-601W2	FASTENER	4	

16 WIRING MATERIAL

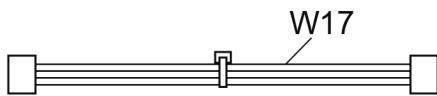
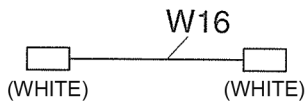
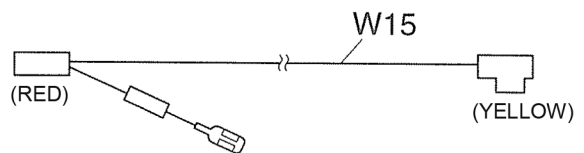
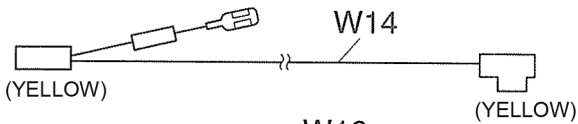
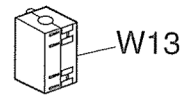
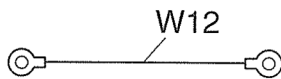
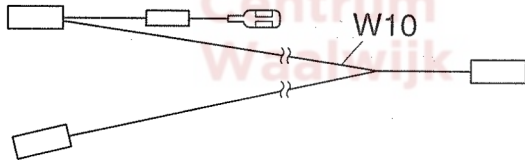
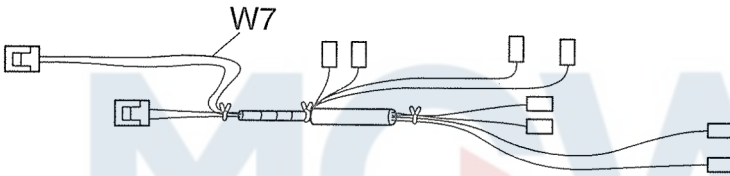
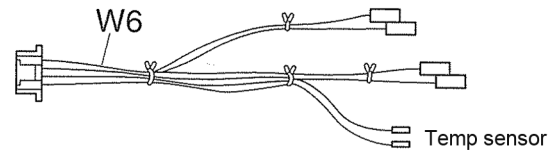
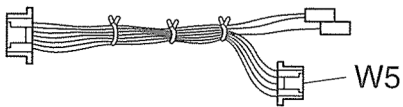
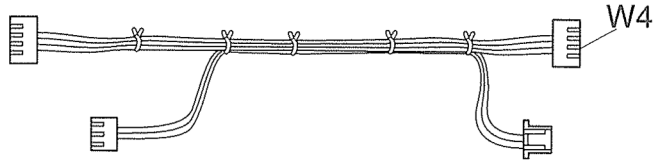
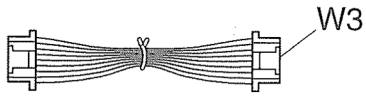
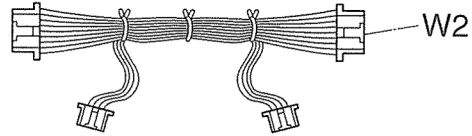
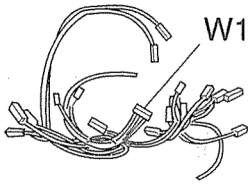

(S-3A4 BDQ)
 (S-3A5 EYG)
 (S-3A7 EYG)

NE-2140

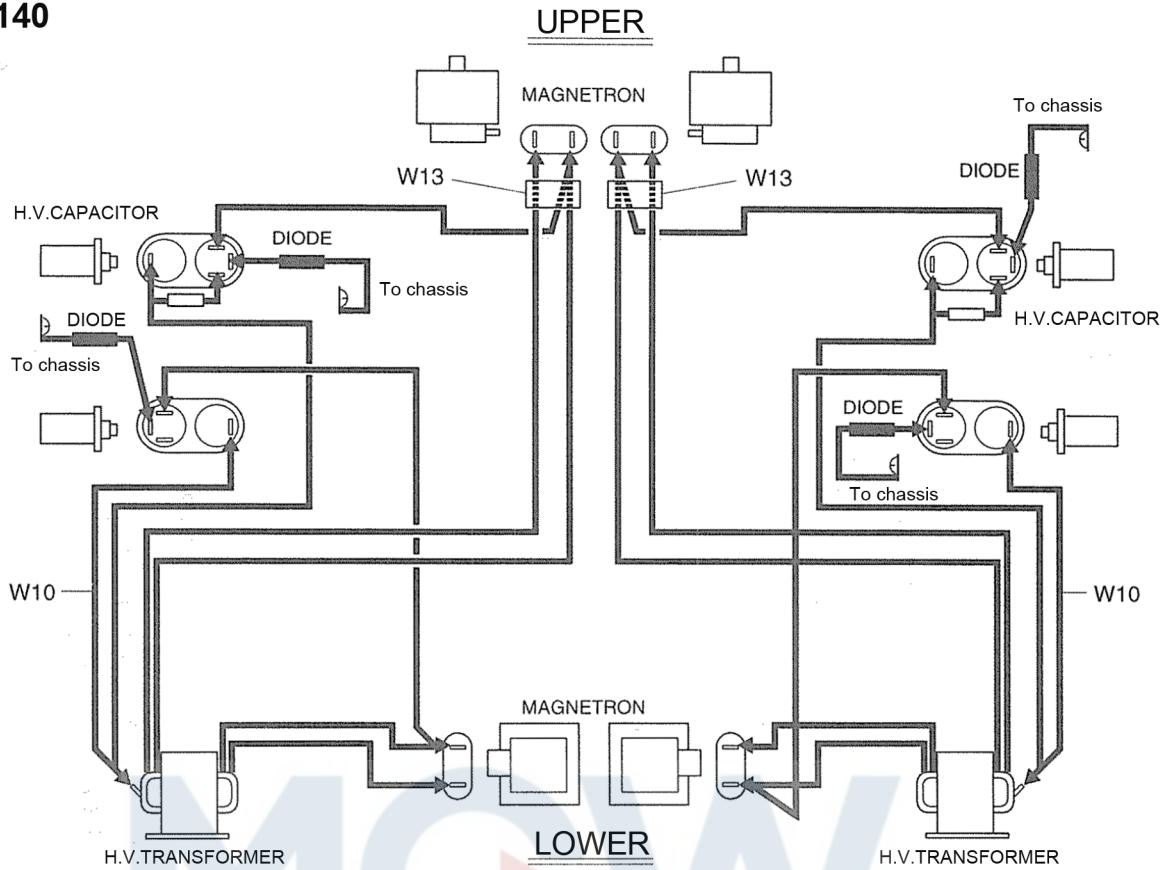

(S-3A7 EYG)

NE-3240, NE-3280

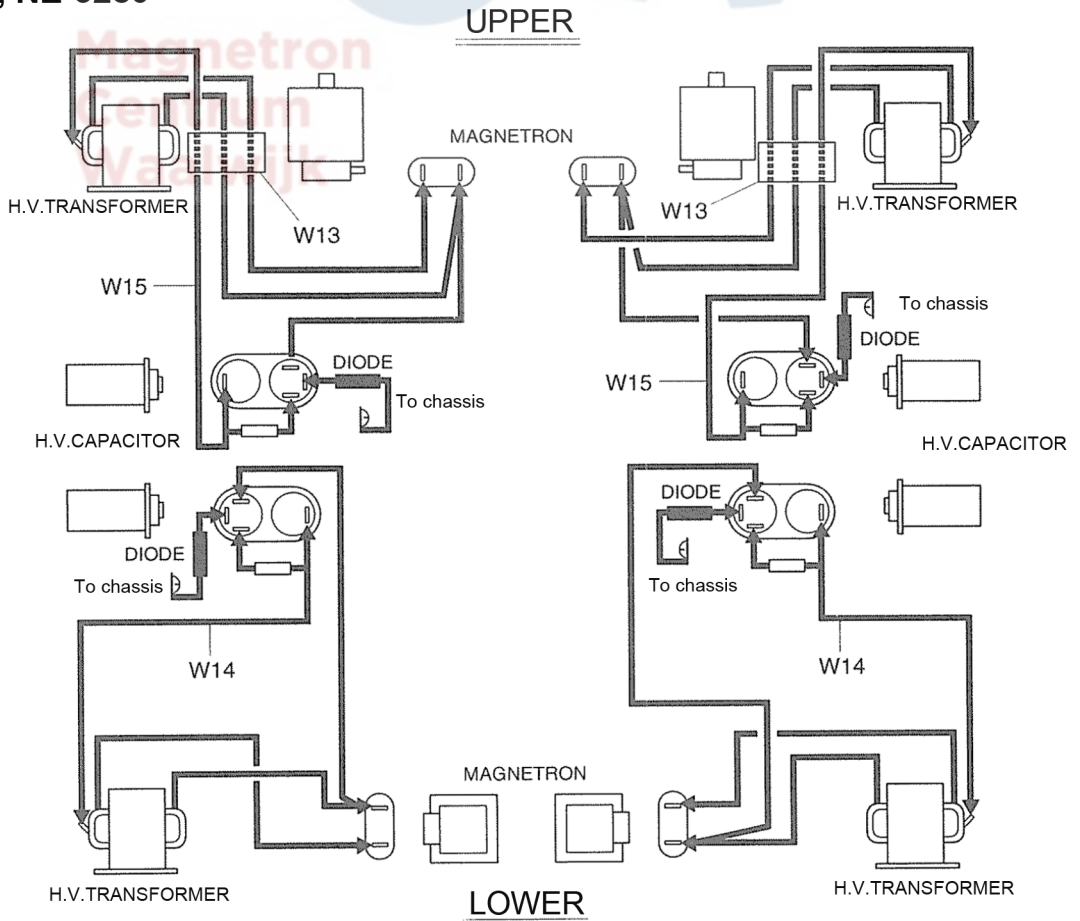

(S-3A4 BDQ)

Safety	Ref. No.	Part No.	Part Name & Description	Pcs/set	Remarks
	W1	F030A3A70EU	LEAD WIRE HARNESS	1	NE-2140EYG
	W1	F030A3A50EU	LEAD WIRE HARNESS	1	NE-3240EYG
	W1	F030A3560BP	LEAD WIRE HARNESS	1	NE-3280BDQ
	W2	F03603560GP	LEAD WIRE	1	
	W3	F03623560GP	LEAD WIRE	1	
	W4	F03633560GP	LEAD WIRE	1	
	W5	F03643560GP	LEAD WIRE	1	NE-3240EYG, NE-2140EYG
	W6	F03653560GP	LEAD WIRE	1	
	W7	F03693560GP	LEAD WIRE	1	
	W8	F03703560GP	LEAD WIRE	1	
	W10	F606V3580GP	PROTECTOR DIODE	2	NE-2140EYG
	W12	F03813030GP	LEAD WIRE	2	NE-3240EYG, NE-2140EYG
	W13	A50953310BP	FERRITE CORE	4	
	W14	F606V3560GP	PROTECTOR DIODE	2	NE-3280BDQ, NE-3240EYG
	W15	F606W3560GP	PROTECTOR DIODE B	2	NE-3280BDQ, NE-3240EYG
	W16	F03733560GP	LEAD WIRE	1	NE-3240EYG, NE-2140EYG
	W17	F03553H00EU	LEAD WIRE	1	FOR TIMER (ROTARY ENCODER)
	W18	A50963A70EU	FERRITE CORE	1	NE-2140EYG FOR POWER CORD(EARTH WIRE)

